

Miller[®]matic 350/350P

Issued August 2007 • Index No. DC/12.51

**MIG Arc Welding
Power Source** 

Quick Specs

Industrial Applications

Fabrication
Maintenance and Repair
Farm
Manufacturing
Industrial

Processes

MIG (GMAW)
Pulsed MIG (GMAW-P)*
Flux Cored (FCAW)

*With 350P Model Only

Rated Output 300 A at 32 VDC, 60% Duty Cycle, 60 Hz, 1- or 3-Phase Input Power

Amperage Range 25–400 A

Wire Feed Speed 50–700 IPM (1.3–18 m/min) MIG Gun
50–800 IPM (1.3–20 m/min) Spool Gun/ Push-Pull Gun

Weight 181 lb (82 kg)

The Power of Blue.[®]

Built-in pulsed MIG programs (Miller[®]matic 350P only)

- .035 and .045 in (0.9 and 1.2 mm) for mild or stainless steel.
- .035 and .047 in (0.9 and 1.2 mm) for 4000 and 5000 series aluminum.
- .045 in (1.2 mm) for metal core.

All programmed information is stored for MIG, push-pull and spool guns, and is restored after each power up.

1- or 3-phase input power with **Line Voltage Compensation** for constant output even with fluctuations to the input power.

Aluminum Pulse Hot Start[™] (Miller[®]matic 350P only)

automatically provides more arc power to eliminate a “cold start” that is inherent with aluminum starts.

Superior Aluminum Performance—direct connection for optional XR[™] push-pull guns or Spoolmatic[®] spool gun. With Miller's exclusive **Gun-On-Demand**, simply pull the trigger for the gun to be used and you're ready to weld.

Fan-On-Demand cooling only operates when needed, reducing power consumption and contaminants inside the unit.

Industrial, 4-roll wire drive system features two easy-to-set, scaled, tension adjustments and quick-change reversible drive rolls for .035 and .045 in (0.9 and 1.2 mm) wire.



**XR-Aluma-Pro[™] Push-Pull Gun
Aluminum Welding System**
now available. See page 3.



**Welds materials 22 gauge up
to 1/2 in (12.7 mm) thick.**



Power source is warranted for 3 years, parts and labor.
Original main power rectified parts are warranted for 5 years.
Gun warranted for 90 days, parts and labor.

Standard MIG System Comes Complete with:

- Bernard[®] Q300 15 ft (4.6 m) MIG gun with extra Centerfire[™] contact tips
- 10 ft (3 m) Industrial power cord (without plug) for single- or three-phase
- 10 ft (3 m) work cable with clamp
- Factory-installed gas solenoid
- Argon mix regulator/flow meter
- Factory-installed, low-mounted running gear/cylinder rack
- .035/.045 in (0.9/1.2 mm) reversible V-groove drive rolls (order U-groove drive roll kits for aluminum welding)
- Set-up and operation CD

Special Features

- Run-in adjustment for MIG, push-pull and spool guns.
- Built-in 2-minute spot timer.
- Pre-flow and post-flow adjustment.
- View actual welding amperage/voltage during welding, and 5 seconds after arc has shutoff.
- SharpArc[™] controls welding arc cone width in pulsed MIG welding mode.
- Inductance control customizes weld output characteristics in MIG welding mode.

Exclusive Internal Timers

- **Adjustable crater** feature optimizes crater size for steel, stainless, aluminum and metal-core applications.
- **Crater Time Delay** allows deactivation of crater feature for tack or small welds.
- **Wire Jog Mode**
 - If trigger is pressed and no arc is detected after 3 seconds, the welding output will be shut off and the unit will go into JOG MODE for feeding wire to the gun.
 - Gas Saver—Gas will automatically shutoff after 1 minute when no arc has been detected.
 - Wire Saver—Wire drive will automatically shutoff after 2 minutes when no arc has been detected.



Miller Electric Mfg. Co.
An Illinois Tool Works Company
1635 West Spencer Street
Appleton, WI 54914 USA

International Headquarters
Phone: 920-735-4505
USA FAX: 920-735-4134
Canadian FAX: 920-735-4169
International FAX: 920-735-4125

Web Site
www.MillerWelds.com

MADE IN **USA**
APPLETON, WI **USA**



Specifications (Subject to change without notice.)



Rated Output	Amperage Range	Amps Input at Rated Output, 60 Hz						Wire Type and Diameter	Wire Feed Speed	Dimensions	Net Weight
		200 V	230 V	460 V	575 V	KVA	KW				
Three-phase 300 A at 32 V 60% Duty Cycle	25-400 A	34	30	15	12	11.6	11.5	Solid Steel: .023-.045 in (0.6-1.2 mm) Aluminum: .035-.047 in (0.9-1.2 mm) Flux Core: .030-.045 in (0.8-1.2 mm) Metal Core: .035-.052 in (0.9-1.3 mm)	MIG Gun: 50-700 IPM (1.3-18 m/min) Spool Gun and Push-Pull Gun: 50-800 IPM (1.3-20 m/min)	H: 34 in (863 mm) W: 19 in (483 mm) D: 41 in (1041 mm)	181 lb (82 kg)
Single-phase 300 A at 32 V 60% Duty Cycle		69	61	30	24	13.1	11.2				

Certified by Canadian Standards Association to both Canadian and U.S. Standards.

Control Panel

1. Weld Mode Indicator Lights
2. Menu Set-Up Button
3. Adjustment Knobs
4. Weld Parameter Displays
5. Weld Function Indicator Lights
6. Arc Control Button

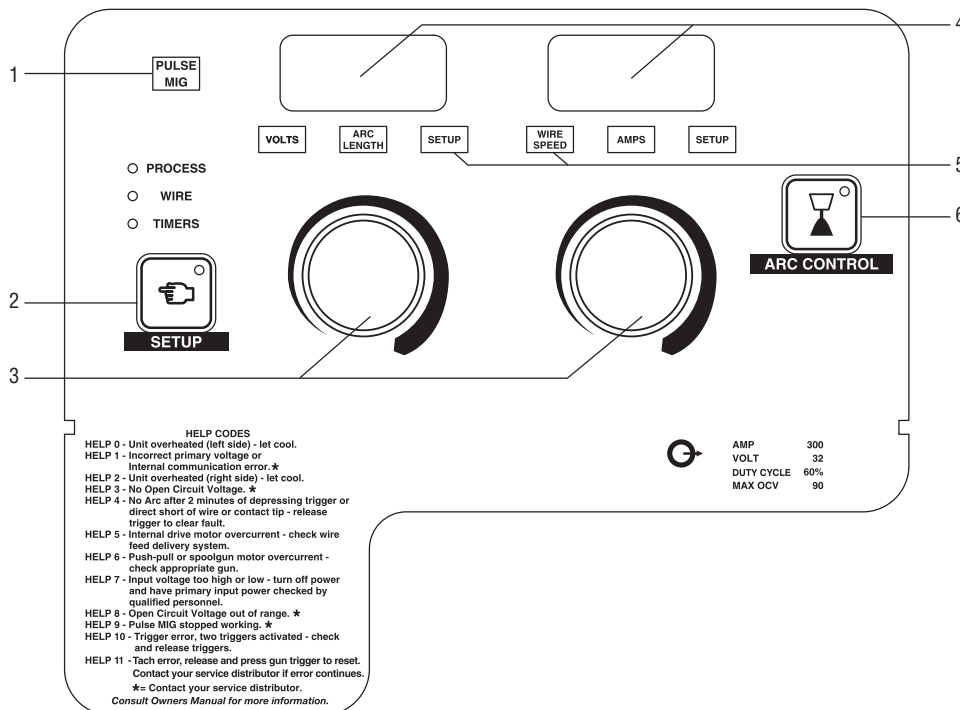

Performance Data

DUTY CYCLE CHART

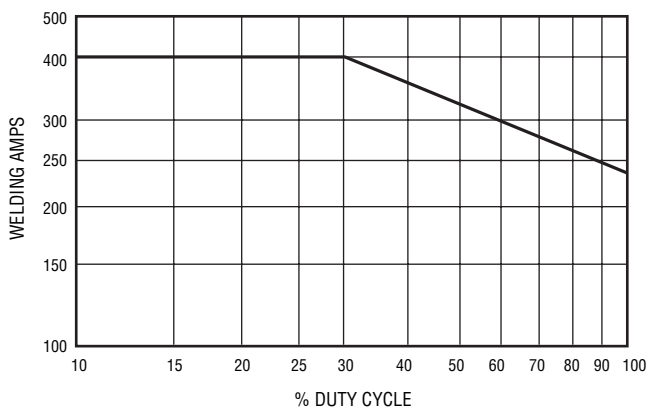

VOLT/AMP CURVES

